

# Lumen Tech

Lighting, Inc.

## Design QSC25 Constellation Series Wall Sconce Maximum 400W Metal Halide Or High Pressure Sodium

### Specifications

**Housing:** Heavy duty cast aluminum with quick mount system. Powder coated finish. See finish note.

**Lens:** Clear tempered glass silicone sealed to door frame.

**Reflector:** Anodized aluminum, computer designed for efficiency, [classified full cut-off dark sky compliant](#).

**Ballast:** Pre-wired C.W.A., H.P.F. core and coil with capacitor.

**Lamp:** Clear mogul base (by others).

**Lamp Holder:** High heat 4 K.V. rated, w/nickel plated copper screw shell, spring loaded center contact.

**Finish:** Bronze, detergent cleaned, prime coated chip resistant powder urethane polyester coating. Contact factory for other colors.

**Photometric Information:** Contact factory.

**Labels:** U/L listed suitable for wet location.

*SPECIFICATIONS SUBJECT TO CHANGE WITHOUT NOTICE*



**DARK SKY  
COMPLIANT  
IES FULL CUTOFF**

### Ordering Information

Catalog Number	Watts	Light Source
QSC25250H	250	HPS
QSC25400H	400	HPS
QSC25250MP	250	MH Pulse Start
QSC25325MP	325	MH Pulse Start
QSC25350MP	350	MH Pulse Start
QSC25400MP	400	MH Pulse Start

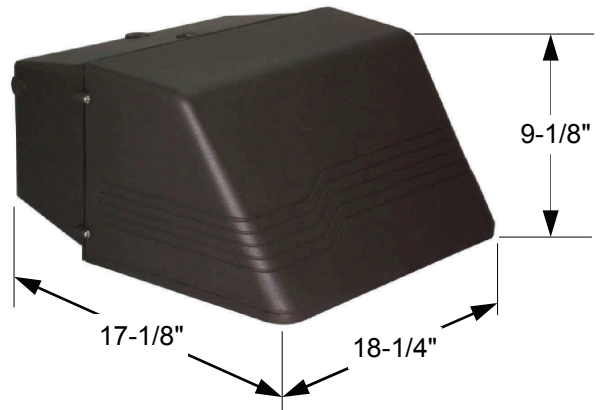

# Lumen Tech

Lighting, Inc.

## Design QSC25 Constellation Series Wall Sconce Maximum 400W Metal Halide Or High Pressure Sodium

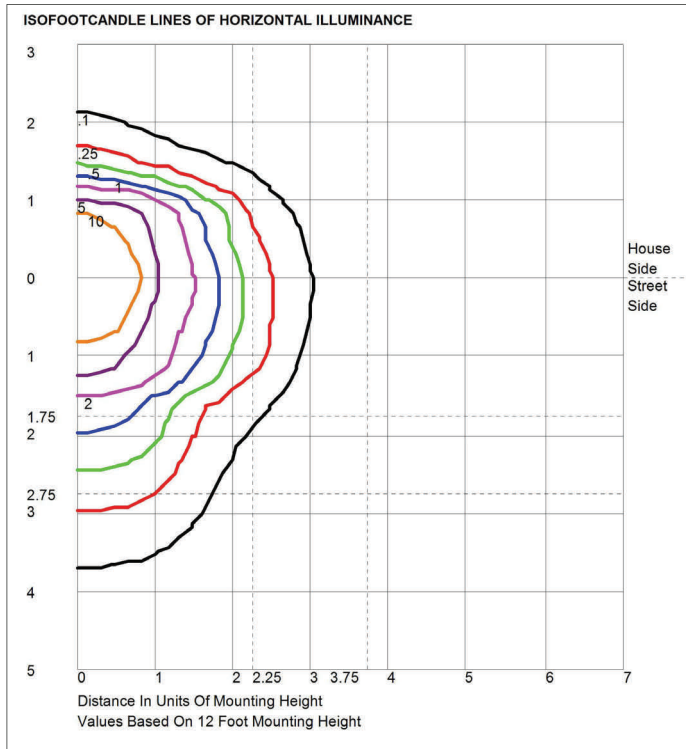

Report Number	QSC2025M.IES
IES Classification	Type III
Cutoff Classification	Full Cutoff
Lamp	250W Clear MH ED28
Total Lamp Lumens	20500
Total Luminaire Watts	290W
Lens	Clear Tempered Glass

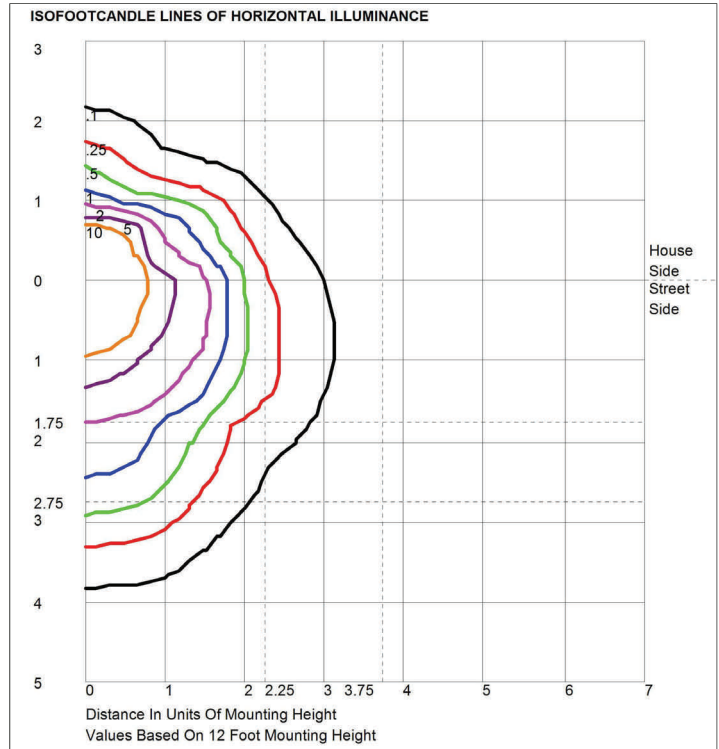

Report Number	QSC2025H.IES
IES Classification	Type III
Cutoff Classification	Full Cutoff
Lamp	250W Clear HPS ET18
Total Lamp Lumens	29000
Total Luminaire Watts	295W
Lens	Clear Tempered Glass

### Options

<b>PC(Voltage)</b>	Photocell Control
<b>QRS</b>	Quartz Re-strike System (Less Lamp)
<b>QRST</b>	Time Delay Quartz Re-strike System (Less Lamp)
<b>MR16-1</b>	GU5.3 Two Pin Socket for 12V Power (By Others)
<b>MR16-2</b>	2-GU5.3 Two Pin Sockets for 12V Power (By Others)
<b>FD(Voltage)</b>	Fusing

### Accessories

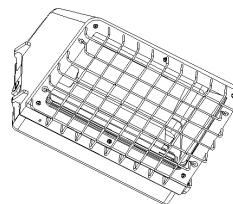

Wireguard option order catalog# **QSC25WG**.

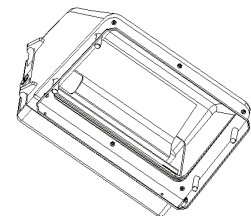

Polycarbonate shield option order catalog#